

# FENICE 11

PELLET AIR - Pellet stoves

# CADEL

Certificate model name : FENICE 11 T1



Nominal power	kW	10,5
Reduced power	kW	3
Introduced thermal power (max)	kW	11,6
Nominal water useful power	kW	-
Reduced water useful power	kW	-
Nominal efficiency	%	90
Reduced efficiency	%	90
Heating volume (min-max)	m <sup>3</sup>	84 - 294
Nominal CO at 13% O <sub>2</sub>	%	0,013
Reduced CO at 13% O <sub>2</sub>	%	0,022
Emissions CO (13% O <sub>2</sub> ) (min-max)	mg/Nm <sup>3</sup>	230 - 159
Emissions OGC (13% O <sub>2</sub> ) (min-max)	mg/Nm <sup>3</sup>	5 - 5
Emissions NOX (13% O <sub>2</sub> ) (min-max)	mg/Nm <sup>3</sup>	130 - 100
Dust content at 13% O <sub>2</sub> (min-max)	mg/Nm <sup>3</sup>	20 - 15
Boiler capacity (H <sub>2</sub> O)	l	-
Hopper capacity	kg	20
Combustible		Pellet ø6
Hourly consumption (min-max)	kg/h	0,7 - 2,5
Autonomy (min-max)	h	29 - 8
Ignition electrical absorption (max)	W	340
Operating electrical absorption (max)	W	110
Supply and frequency	V - Hz	230 - 50
Chimney flue depression	Pa	12
Exhaust diameter	mm	80
Combustion air inlet diameter	mm	60
Mass of smoke (min-max)	g/sec	4 - 8
Exhaust fumes temperature (max)	°C	175
Net weight	kg	130
Gross weight	kg	140
Exhaust fumes	see	A
Hole combustion air inlet	see	B
Ducting outlet	see	-
Ducting capability up to	m	-

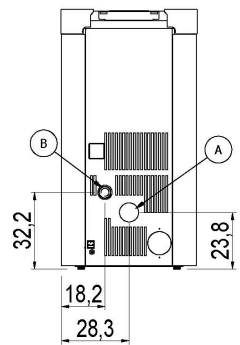
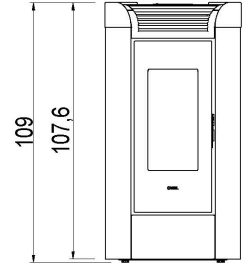
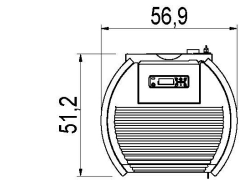

Art. 15A-B-VG 2015  
BimSchV 2015  
Regensburg  
München  
Stuttgart  
Aachen



## MATCH

7022058		White - gold steel	EAN 8053859015352
7022059		Titanium - anthracite steel	EAN 8053859015369
7022060		Anthracite - titanium steel	EAN 8053859015476

## OPTIONAL :

5022002		Upper + concentric exhaust kit	EAN 8053859015543
---------	--	--------------------------------	-------------------

## PLUS



Cast iron burning pot



Sealed chamber



Cast iron inner



Integrated Wi - Fi



Connection to the room thermostat



Comfort mode



Back exhaust



Bluetooth



Cast iron door



Daily weekly programming



Concentric flue kit (optional)

## STOVE PACKING

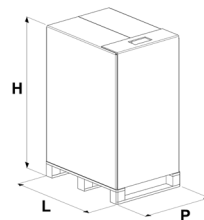

L (cm)	H (cm)	P (cm)
80	125	65

VOLUME (m <sup>3</sup> )
0,65

## LINING PACKING

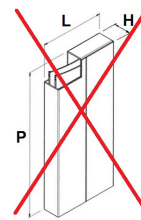

L (cm)	H (cm)	P (cm)

## STOCKING

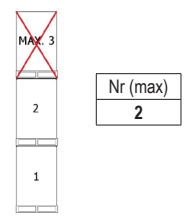

## TRANSPORT

