

# SHELL 9 UP

PELLET AIR - Pellet stoves

# CADEL

Certificate model name : SHELL 3 PS



Nominal power	kW	9,1
Reduced power	kW	2,4
Introduced thermal power (max)	kW	10,3
Nominal water useful power	kW	-
Reduced water useful power	kW	-
Nominal efficiency	%	88,7
Reduced efficiency	%	92,9
Heating volume (min-max)	m <sup>3</sup>	58 - 218
Nominal CO at 13% O <sub>2</sub>	%	0,005
Reduced CO at 13% O <sub>2</sub>	%	0,022
Emissions CO (13% O <sub>2</sub> ) (min-max)	mg/Nm <sup>3</sup>	274 - 63
Emissions OGC (13% O <sub>2</sub> ) (min-max)	mg/Nm <sup>3</sup>	3,9 - 2,1
Emissions NOX (13% O <sub>2</sub> ) (min-max)	mg/Nm <sup>3</sup>	104 - 139
Dust content at 13% O <sub>2</sub> (min-max)	mg/Nm <sup>3</sup>	19,3 - 12,1
Boiler capacity (H <sub>2</sub> O)	l	-
Hopper capacity	kg	17
Combustible		Pellet ø6
Hourly consumption (min-max)	kg/h	0,53 - 2,12
Autonomy (min-max)	h	8 - 32,1
Ignition electrical absorption (max)	W	346
Operating electrical absorption (max)	W	77
Supply and frequency	V - Hz	230 - 50
Chimney flue depression	Pa	11,6
Exhaust diameter	mm	80
Combustion air inlet diameter	mm	130
Mass of smoke (min-max)	g/sec	2,2 - 5,0
Exhaust fumes temperature (max)	°C	204,6
Net weight	kg	88
Gross weight	kg	98
Exhaust fumes	see	A
Hole combustion air inlet	see	B
Ducting outlet	see	-
Ducting capability up to	m	-

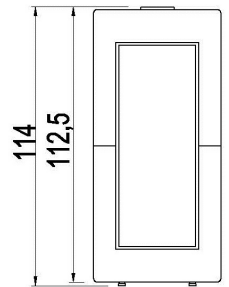
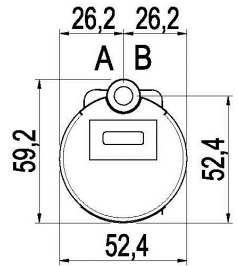

Art. 15A B-VG 2015  
BImSchV 2016  
Regensburg  
München  
Stuttgart  
Aachen



## MATCH

7019018		Anthracite steel	EAN 8053859010777
7019019		White steel	EAN 8053859010784
7019020		Dark bronze steel	EAN 8053859010791
7019021		Titanium steel	EAN 8053859010807

## PLUS



Cast iron burning pot



Sealed chamber



Aluminium Auger



Connection to the room thermostat



Comfort mode



Upper exhaust



Concentric kit



Daily weekly programming



Bluetooth



Magic Glass



Integrated Wi-Fi

## STOVE PACKING

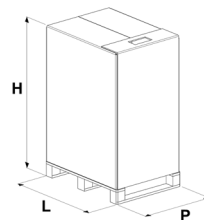

L (cm)	H (cm)	P (cm)
80	131,4	70

VOLUME (m <sup>3</sup> )	0,74
--------------------------	------

## LINING PACKING

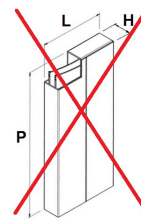

	L (cm)	H (cm)	P (cm)
	-	-	-

## STOCKING

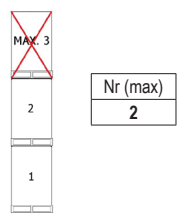

## TRANSPORT

