

# Alexa eModul Smart Application Instructions

# Requirements

You will need the following in order to use the eModul Smart application with Alexa:

1. Android or iOS device
2. Amazon account
3. Amazon Echo device (optional, however this device provides a richer experience)

## Installing the Mobile App and connecting Amazon Echo to your Amazon account

1. Install the app *Amazon Alexa* on your iOS or Android devices, found either in the Apple Store or Google Play Store.
2. Sign in using your Amazon account
3. Open the side menu by tapping the icon in the top left corner, followed by *Add Device* and then *Amazon Echo* (note: if you aren't using an Amazon Echo device, you may skip to step 5.)

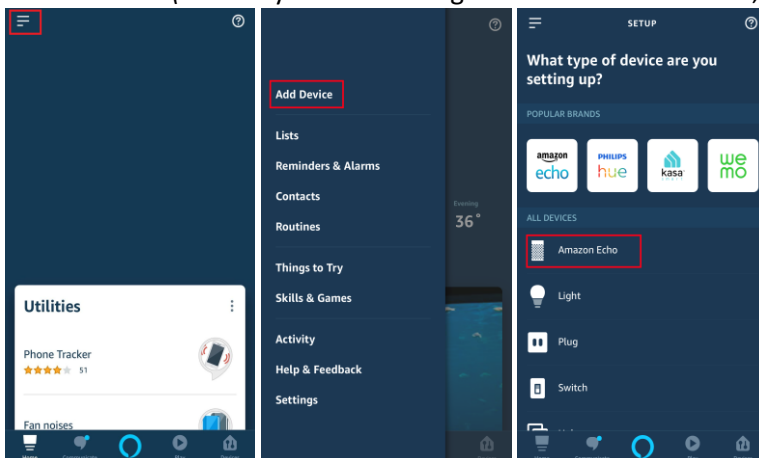

4. Follow the instructions for setting up your Amazon Echo device until it is connected to your account

5. Open the side menu again, tap *Skills & Games*, then the search (magnifying glass) icon and type “emodul smart”

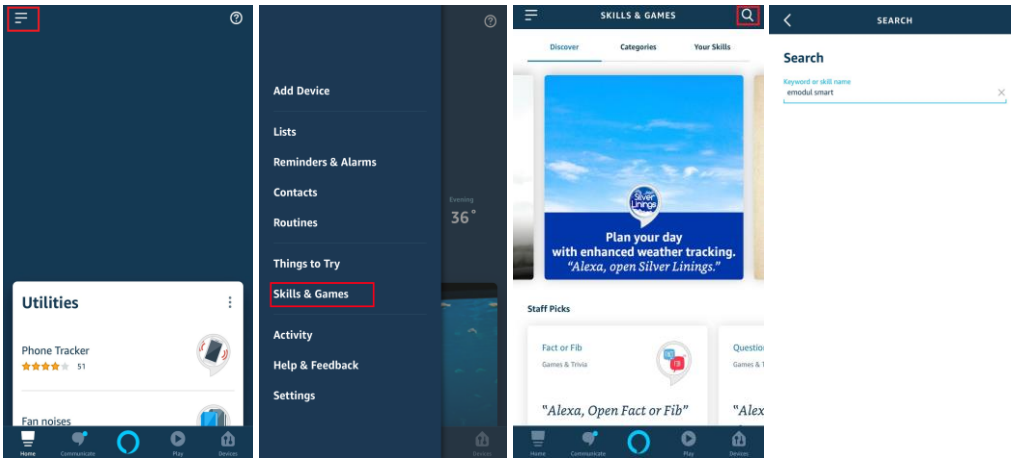

6. Tap the skill *eModul Smart*, followed by *ENABLE TO USE*

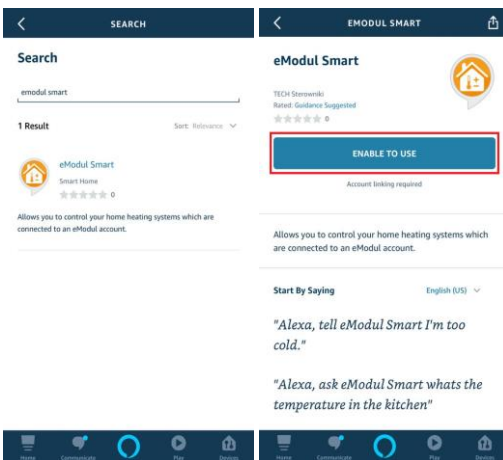

7. Enter your credentials and sign in to your *eModul* account. Once you see “eModul Smart has been successfully linked”, click on the X in the upper right corner.

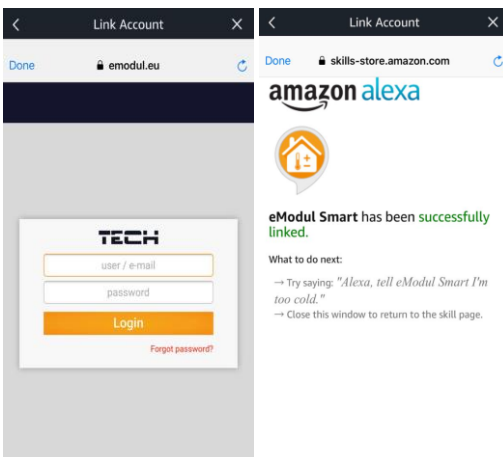

8. Pat yourself on the back. You have successfully added the *eModul Smart* skill and are now ready to use it with Alexa.

# Alexa eModul Smart commands

There are 5 different actions which Alexa can perform with eModul Smart:

1. Getting the temperature
2. Setting the temperature to a specific temperature (e.g. 24.5 °C)
3. Changing the temperature by a specified increment (e.g. by 2.5 °C)
4. Listing all zones which are turned on
5. Toggling zone states between on/off.

## Using the commands

Each command has their own invocations. You can invoke them in one of two ways.

1. **Opening the eModul Smart app** by saying “Alexa, open eModul Smart” followed by the command’s invocation once Alexa has finished introducing the app.
2. **Directly calling the command** by saying “Alexa, ask/tell eModul Smart...” along with the command’s invocation. E.g. “Alexa, ask eModul Smart what’s the temperature in the kitchen.” or “Alexa, tell eModul Smart I’m too cold”

### Getting the Temperature

- What’s the temperature in the kitchen?
- What the temperature is in the laundry room?
- What’s the temperature in the bathroom?
- What’s the temperature?

#### Dialog options

In cases which the user does not provide a zone name, Alexa will prompt the user for a zone.

**User:** What’s the temperature?

**Alexa:** Ok, I’ll check the temperature for you. In which zone would you like to know the temperature?

**User:** In the kitchen.

## Setting the Temperature

- Set the bathroom to 23.2 degrees.
- Set the kids' room to 22 for half an hour.
- Set the temperature for 45 minutes.
- Set the temperature for 5 and a half hours.
- Set the temperature.

### Specifying time

You can specify the time in the following ways:

- Minutes e.g. 35 minutes, 90 minutes
- Hours e.g. 1 hour, 12 hours
- Half hour (equivalent to 30 minutes), invoked by saying "half hour", "a half hour" or "half an hour"
- Hour and a half e.g. "1 and a half hours" or "14 and a half hours"

### Dialog options

In cases which the user does not provide a zone name and temperature, Alexa will prompt the user for a zone.

#### Constant temperature

**User:** Set the temperature.

**Alexa:** Ok, let's set the temperature. In which zone would you like to set it?

**User:** In the living room.

**Alexa:** What would you like to set the temperature in the living room to?

**User:** 24.5 degrees.

#### Setting the temperature for a duration of time

**User:** Set the temperature for 2 hours.

**Alexa:** Ok, let's set the temperature for 2 hours. In which zone would you like to set it?

**User:** In the kitchen.

**Alexa:** What would you like to set the temperature in the kitchen to?

**User:** 25.

## Changing the Temperature by an increment

- I'm too cold.
- It's too warm in the kitchen.
- Set the temperature.

### Dialog options

In cases which the user does not provide a zone name, Alexa will prompt the user for a zone.

**User:** I'm too hot.

**Alexa:** I'm sorry to hear that. I can lower the temperature for you. Which zone are you in?

**User:** I'm in the kitchen.

**Alexa:** Ok, by how much shall I lower the temperature in the kitchen?

**User:** By 5 degrees.

## Listing Zones

- What are my zones?
- What zones do I have?
- Which zones are on?
- Which zones are connected?
- What my zones are

## Toggling zone on/off

- Turn off the bedroom.
- Turn on the kitchen

**All zone names** can be referred to with or without "the" or "my".

e.g. "the kitchen", "my kitchen" or "kitchen"

**All temperatures** can be given with or without "degrees" or "degrees Celsius" and may contain an optional decimal value.

e.g. "22", "22 degrees", "22 degrees Celsius" or "22.2 degrees Celsius"