

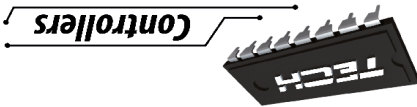

Tel. +48 33 8759380, +48 33 3300018
 +48 33 8751920, +48 33 8704700
 serwis@techsterowniki.pl
 Zgłoszenia serwisowe przyjmowane są:
 Monday - Friday 7:00 - 16:00
 Saturday 9:00 - 12:00

SERWIS
 32-652 Bulojowice,
 ul. Skotnica 120

USER'S MANUAL C-2



TECH STEROWNIKI
 Spółka z ograniczoną odpowiedzialnością SP. z o.o.
 Biata Droga 31
 34-122 Wieprz

WARRANTY CARD

TECH company ensures to the Buyer proper operation of the device for the period of 24 months from the date of sale. The Guarantor undertakes to repair the device free of charge if the defects occurred through the manufacturer's fault. The device should be delivered to its manufacturer. Principles of conduct in the case of a complaint are determined by the Act on specific terms and conditions of consumer sale and amendments of the Civil Code (Journal of Laws of 5 September 2002).

CAUTION! THE TEMPERATURE SENSOR CANNOT BE IMMersed IN ANY LIQUID (OIL ETC). THIS MAY RESULT IN DAMAGING THE CONTROLLER AND LOSS OF WARRANTY! THE ACCEPTABLE RELATIVE HUMIDITY OF THE CONTROLLER'S ENVIRONMENT IS 5÷85% REL.H. WITHOUT THE STEAM CONDENSATION EFFECT.

THE DEVICE IS NOT INTENDED TO BE OPERATED BY CHILDREN.

Activities related to setting and regulation of the controller parameters described in the Instruction Manual and parts wearing out during normal operation, such as fuses, are not covered by warranty repairs. The warranty does not cover damages arising as a result of improper operation or through the user's fault, mechanical damage or damage created as a result of fire, flood, atmospheric discharges, overvoltage or short-circuit. The interference of an unauthorized service, wilful repairs, modifications and construction changes cause the loss of Warranty. TECH controllers have protective seals. Removing a seal results in the loss of Warranty.

The costs of unjustifiable service call to a defect will be borne exclusively by the buyer. The unjustifiable service call is defined as a call to remove damages not resulting from the Guarantor's fault as well as a call considered unjustifiable by the service after diagnosing the device (e.g. damage of the equipment through the fault of the client or not subject to Warranty), or if the device defect occurred for reasons lying beyond the device.

In order to execute the rights arising from this Warranty, the user is obliged, at his own cost and risk, deliver the device to the Guarantor along with a correctly filled-in warranty card (containing in particular the sale date, the seller's signature and a description of the defect) and sales proof (receipt, VAT invoice, etc.). The Warranty Card is the only basis for repair free of charge. The complaint repair time is 14 days.

When the Warranty Card is lost or damaged, the manufacturer does not issue a duplicate.

.....
 seller's stamp

.....
 date of sale

Description

C-2 sensor is intended to be installed on the windows of particular heating zones. When the window is opened, the sensor sends the information to the main controller which deactivates heating in the zone after a pre-set delay time.



Installation

In order to install C-2 sensor, place double-sided tape on the upper part of the window frame (not where the hinges are located) and stick the back of the sensor to the tape. Next, put the front part of the sensor in its place. The installation method is illustrated in the picture below.



NOTE

The magnet should be placed on the window casement!

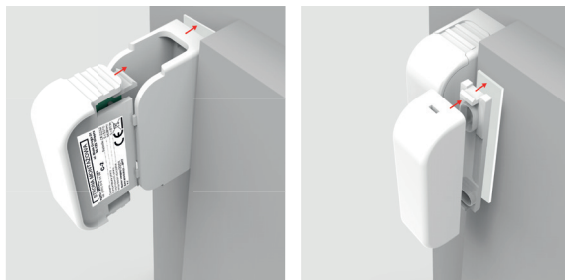

Sensor registration

Once 'Registration' function in the main controller has been activated, press quickly the communication button on a given C-2 sensor.

If the registration attempt has been successful, the main controller will display an appropriate message and the control light on C-2 sensor will flash twice.

If the control light goes on permanently, there is no communication with the main controller.

Technical data

Communication frequency.....868 MHz
Range (in open area).....30 m
Power supply.....CR2032 battery
Operation temperature.....5-50°C
Air humidity.....5-85%

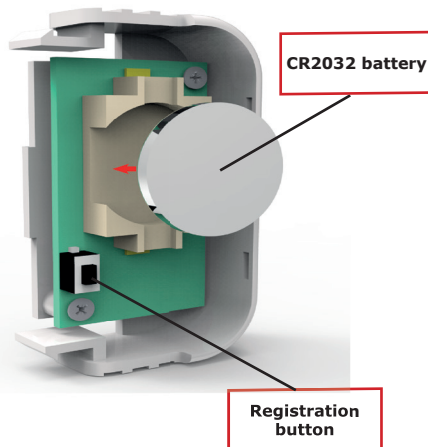

Safety

Before using the device for the first time the user should read the following regulations carefully. Not obeying the instructions included in this manual may lead to personal injuries or controller damage.

The user's manual should be stored in a safe place for further reference.

In order to avoid accidents and errors it should be ensured that every person using the device has familiarized themselves with the principle of operation as well as security functions of the controller. If the device is to be sold or put in a different place, make sure that the user's manual is there with the device so that any potential user has access to essential information about the device.

The manufacturer does not accept responsibility for any injuries or damage resulting from negligence; therefore, users are obliged to take the necessary safety measures listed in this manual to protect their lives and property.



We are committed to protecting the environment. Manufacturing electronic devices imposes an obligation of providing for environmentally safe disposal of used electronic components and devices. Hence, we have been entered into a register kept by the Inspection For Environmental Protection. The crossed-out bin symbol on a product means that the product may not be disposed of to household waste containers. Recycling of wastes helps to protect the environment. The user is obliged to transfer their used equipment to a collection point where all electric and electronic components will be recycled.